

PMA EMC System

Cable Protection System providing electro-magnetic shielding

EMC System

Introduction

The PMA EMC System provides an additional function within the PMA Cable Protection System, offering high quality shielding against electro-magnetic signals over and above the mechanical cable protection. The EMC product line includes screening braids (tin-plated copper and hybrid braids) and a range of patented termination fittings (metallic components in nickel plated aluminium or nickel plated brass). The EMC system can be combined with any type of PMA conduit to provide the mechanical protection.



Transfer impedance

The F.CK, F.CU and F.HY screening braids provide excellent shielding for electro-magnetic signals. The patented EMC fittings allow a low impedance 360° termination of the braid preventing stray signals and an earth connection via the termination thread, in addition to the standard water and dust tight conduit termination.

— 01 Screening effectiveness of PMA screening braid (typical values).

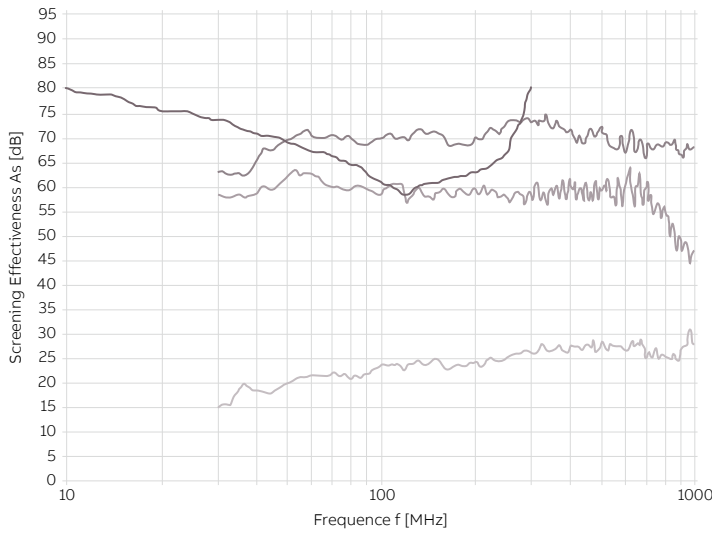

Screening Effectiveness As (according to IEC 96-1)

- F.HY
- F.CK
- F.CU
- MEPLA*

* MEPLA is a standard metal plastic conduit.

— 02 Transfer impedance between housing PMA-EMCFIX in conjunction with PMA screening braid (typical values).

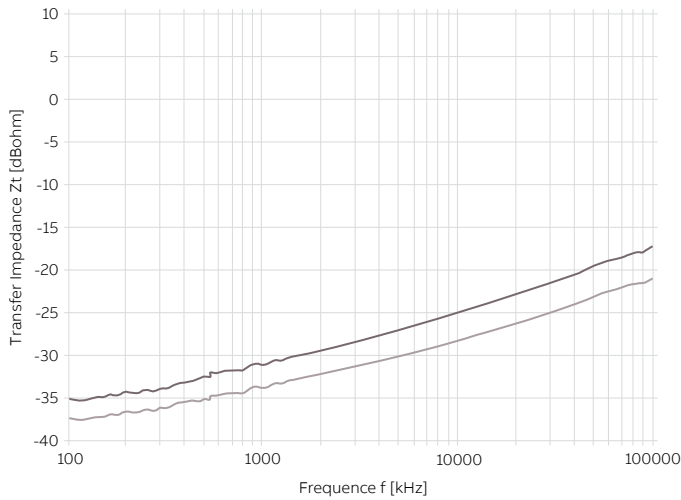

Transfer Impedance based on the Triaxial-Methode (Vector Analyzer MS3606B)

- HFAK/HFA
- VEM/VIM

EMC System

Metal and polyester braids



F.CK – Screening braid

- Finest tin-plated copper wires
- Delivered on tube former
- Coverage: > 90%

Order No.	NW	Braid specification	Cross section mm ²	Operative range		Weight net per 100 m*
				min. Ø	max. Ø	
F.CK.03	3	16 x 5 x 0.13	1.06	2.5 mm	3.5 mm	1.3 kg
F.CK.04	4	16 x 7 x 0.13	1.48	3.0 mm	5.0 mm	1.8 kg
F.CK.06	6	24 x 7 x 0.13	2.22	4.5 mm	7.0 mm	2.6 kg
F.CK.10	10	24 x 11 x 0.13	3.50	7.0 mm	12.0 mm	4.1 kg
F.CK.12.5	12.5	24 x 14 x 0.13	4.45	11.0 mm	13.0 mm	5.1 kg
F.CK.15	15	24 x 14 x 0.15	5.93	13.0 mm	18.0 mm	7.0 kg
F.CK.20	20	48 x 10 x 0.15	8.48	16.0 mm	35.0 mm	8.9 kg
F.CK.25	25	48 x 13 x 0.15	11.02	22.0 mm	40.0 mm	12.1 kg
F.CK.30	30	48 x 20 x 0.15	16.96	27.0 mm	44.0 mm	18.8 kg
F.CK.35	35	48 x 20 x 0.15	16.96	35.0 mm	50.0 mm	19.1 kg
F.CK.50	50	36 x 14 x 0.30	35.62	40.0 mm	60.0 mm	40.1 kg

*without tube former

Technical data

Typical screening values: 65–75 dB at 100 MHz

Due to tube former: no fold up of braid, easier processing and installation

Temperature range: –65 °C to +150 °C

EMC System

Metal and polyester braids



F.CU – Screening braid

- Finest tin-plated copper wires
- Coverage: > 65%

Order No.	NW	Braid specification	Cross section mm ²	Operative range		Weight net per 100 m
				min. Ø	max. Ø	
F.CU.01	1	16 x 4 x 0.10	0.5	1.0 mm	3.0 mm	0.5 kg
F.CU.04	4	24 x 7 x 0.10	1.3	3.0 mm	8.0 mm	1.3 kg
F.CU.10	10	24 x 11 x 0.10	2.0	4.0 mm	10.0 mm	2.6 kg
F.CU.12	12	36 x 11 x 0.10	3.1	6.0 mm	15.0 mm	2.9 kg
F.CU.20	20	36 x 8 x 0.15	5.1	12.0 mm	25.0 mm	4.7 kg
F.CU.40	40	48 x 7 x 0.25	16.5	24.0 mm	49.0 mm	22.3 kg
F.CU.50	50	48 x 9 x 0.30	30.5	45.0 mm	55.0 mm	28.2 kg

Technical data

Typical screening values: 60–70 dB at 100 MHz

Temperature range: –65 °C to +150 °C

EMC System

Metal and polyester braids

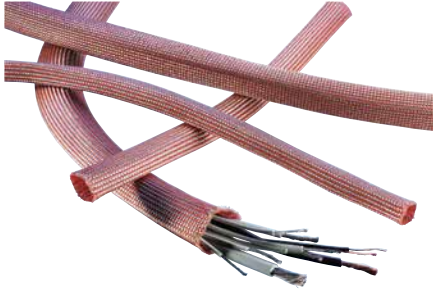

F.HY – Hybrid screening braid, very flexible, lightweight

- Finest tin-plated copper wires mixed with polyester monofilament
- Coverage: > 95%

Order No.	Fits to conduit size NW	Operative range		Weight net (without tube former) per 100 m
		min. Ø	max. Ø	
F.HY.10*	10	8.0 mm	13.0 mm	4.3 kg
F.HY.12*	12	10.0 mm	15.0 mm	4.5 kg
F.HY.15	17	12.0 mm	18.0 mm	6.8 kg
F.HY.20	23	19.0 mm	27.0 mm	7.2 kg
F.HY.35	29	30.0 mm	40.0 mm	12.0 kg
F.HY.40	36, 48	30.0 mm	50.0 mm	17.0 kg

*with tube former

Technical data

Typical screening values: 45 to 67 dB

Very high flexibility, for dynamic applications

Excellent abrasion and vibration resistance

Free from halogens

Colour: metal/red

Temperature range: -40 °C to +150 °C

EMC System

Connectors

PMA EMC connectors are designed for optimal termination of the PMA tinned copper screening braids F.CK, F.CU and the hybrid screening braid F.HY. Partially they can also be used to terminate the shield of screened cables and wires.

The connectors are used to be combined with PMA conduits for flexible protection of screened cables and wires or pre-assembled cable looms against mechanical damage.

General technical details

Material

- Connectors and accessories made of high-grade, specially formulated polyamide 6
- EMV threaded components made of nickel plated aluminium
- Strain relief components made of nickel plated brass

- Free from halogens, REACH + RoHS compliant
- Self-extinguishing
- Temperature range: -40 °C to +105 °C, short-term to +160 °C

Characteristics

- 360° braid termination: high degree of safety in case of short-circuiting
- Low coupling resistances, low transfer impedances
- Disturbance signals, such as electrical signals and magnetic fields will be discharged to the housing/casing
- Very high impact resistance
- High conduit pull-out strengths
- Vibration proof connection to PMA conduits
- Can be pre-assembled in cable harness systems



PMAFIX, IP68

IP68

IP68 static

IP67 dynamic

IP69 according to DIN 40050

- High sealing through additional seal cap
- For highest dynamic applications
- Content of delivery: Conduit sealing cap, locking clip and thread sealing element for male threads (O-ring and/or flat gasket)



PMAFIX Pro



PMAFIX, IP68 + WPS

IP68 + IP69

static + dynamic

- Highest sealing through fully closed system
- For highest dynamic applications
- Content of delivery: Fitting body with locking and sealing element, O-ring for male threads

EMC System

EMC connectors



VEMV – Connector straight, metric metal thread, long and short

Order No. black, IP68	Thread metric	Fits to NW	Fits to F.CK	Fits to F.CU	Fits to F.HY	Thread length	Overall length
BVEMV-M120-5	M12 x 1.5	10	10	10	–	5.0 mm	65.0 mm
BVEMV-M120-10	M12 x 1.5	10	10	10	–	10.0 mm	70.0 mm
BVEMV-M162-5	M16 x 1.5	12	12.5	12	12	5.0 mm	70.0 mm
BVEMV-M162-10	M16 x 1.5	12	12.5	12	12	10.0 mm	75.0 mm
BVEMV-M207-6	M20 x 1.5	17	15	20	15	6.0 mm	80.0 mm
BVEMV-M207-10	M20 x 1.5	17	15	20	15	10.0 mm	84.0 mm
BVEMV-M253-7	M25 x 1.5	23	20 / (25)	20	20	7.0 mm	86.0 mm
BVEMV-M253-11	M25 x 1.5	23	20 / (25)	20	20	11.0 mm	90.0 mm
BVEMV-M329-8	M32 x 1.5	29	25 / (30)	20 / (40)	35	8.0 mm	90.0 mm
BVEMV-M329-13	M32 x 1.5	29	25 / (30)	20 / (40)	35	13.0 mm	95.0 mm
BVEMV-M409-13	M40 x 1.5	29	25 / (30)	20 / (40)	35	13.0 mm	97.0 mm
BVEMV-M406-8	M40 x 1.5	36	30 / (35)	40	40	8.0 mm	100.0 mm
BVEMV-M406-13	M40 x 1.5	36	30 / (35)	40	40	13.0 mm	105.0 mm
BVEMV-M508-9	M50 x 1.5	48	35	40	40	9.0 mm	105.0 mm
BVEMV-M508-14	M50 x 1.5	48	35	40	40	14.0 mm	110.0 mm
BVEMV-M638-10	M63 x 1.5	48	35	40	40	10.0 mm	106.0 mm
BVEMV-M638-14	M63 x 1.5	48	35	40	40	14.0 mm	110.0 mm

Technical data

Very suitable for the use with PMA screening braids

EMC System

EMC connectors



VEMV-SW – Connector straight, metric metal thread, positionable

Order No. black, IP68	Thread metric	Fits to NW	Fits to F.CK	Fits to F.CU	Fits to F.HY	Thread length	Overall length
BVEMV-M207SW-10	M20 x 1.5	17	15	20	15	10.0 mm	107.0 mm
BVEMV-M329SW-13	M32 x 1.5	29	25 / (30)	20 / (40)	35	13.0 mm	123.0 mm
BVEMV-M406SW-13	M40 x 1.5	36	30 / (35)	40	40	13.0 mm	137.0 mm
BVEMV-M508SW-14	M50 x 1.5	48	35	40	40	14.0 mm	145.0 mm
BVEMV-M638SW-14	M63 x 1.5	48	35	40	40	14.0 mm	145.0 mm

Technical data

Very suitable for the use with PMA screening braids

The fitting construction allows completed cable looms to be easily mounted without twisting conduit or cables

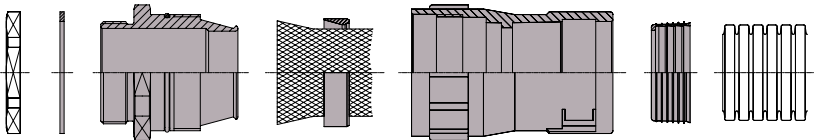

Content of delivery includes grey marked products.

EMC System

EMC connectors with female thread



VIMV – Connector straight, female UN thread for MIL-C5015

Order No. black, IP68	Thread UN	Fits to NW	Fits to F.CK	Fits to F.CU	Fits to F.HY	Thread length	Overall length
BVIMV-U182	¾"-20	12	12.5	12	12	10.0 mm	75.0 mm
BVIMV-U212	7/8"-20	12	12.5	12	12	10.0 mm	75.0 mm
BVIMV-U247	1"-20	17	15	20	15	10.0 mm	85.0 mm
BVIMV-U353	1 7/16"-18	23	20 / (25)	20	20	10.0 mm	92.5 mm
BVIMV-U357	1 7/16"-18	17	15	20	15	10.0 mm	87.0 mm
BVIMV-U433	1 3/4"-18	23	20 / (25)	20	20	10.0 mm	95.0 mm
BVIMV-U569	2 1/4"-16	29	25 / (30)	20 / (40)	35	10.0 mm	95.0 mm
BVIMV-U566	2 1/4"-16	36	30 / (35)	40	40	10.0 mm	110.0 mm
BVIMV-U568	2 1/4"-16	48	35	40	40	10.0 mm	110.0 mm

Technical data

Suitable for MIL connector series C5015

Very suitable for the use with PMA screening braids

Female thread with O-ring

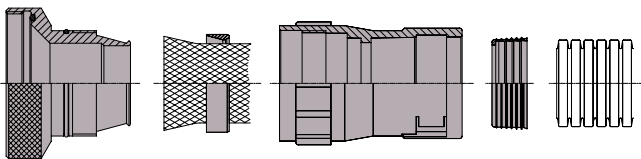

Content of delivery includes grey marked products.

EMC System

EMC connectors with female thread



VIMV – Connector straight, female UNEF thread for MIL-C26482G

Order No. black, IP68	Thread UNEF	Fits to NW	Fits to F.CK	Fits to F.CU	Fits to F.HY	Thread length	Overall length
BVIMV-U212-14	7/8"-20	12	12.5	12	12	14.0 mm	75.0 mm
BVIMV-U247-14	1"-20	17	15	20	15	14.0 mm	90.0 mm
BVIMV-U267-14	1 1/16"-18	17	15	20	15	14.0 mm	90.0 mm
BVIMV-U293-14	1 3/16"-18	23	20	20	20	14.0 mm	90.0 mm
BVIMV-U303-14	1 1/4"-18	23	20	20	20	14.0 mm	90.0 mm
BVIMV-U323-14	1 5/16"-18	23	20	20	20	14.0 mm	90.0 mm
BVIMV-U359-14	1 7/16"-18	29	20	20	35	14.0 mm	95.0 mm

Technical data

Suitable for MIL connector series C26482G

Very suitable for the use with PMA screening braids

No seal on female thread side

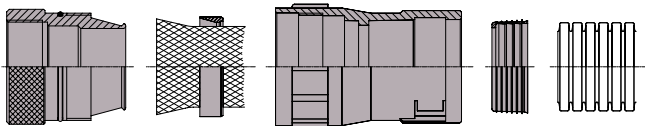

Content of delivery includes grey marked products.

EMC System

EMC adapters



HFAK – Adapter with conical braid clamp, metric thread

Order No. metric	Thread metric		Fits to NW	Fits to F.CK	Fits to F.CU	ID min.	Thread length	Overall length
	1	2						
HFAK-M32/25-13	M32 x 1.5	M25 x 1.5	23	20	20	16.8 mm	13.0 mm	42.0 mm
HFAK-M40/32-13	M40 x 1.5	M32 x 1.5	29	20 / (25)	20	22.4 mm	13.0 mm	51.0 mm
HFAK-M50/40-14	M50 x 1.5	M40 x 1.5	36	30, 50 (35)	40	32.4 mm	14.0 mm	58.0 mm
HFAK-M63/63-14	M63 x 1.5	M63 x 1.5	48	35, 50	40	43.4 mm	14.0 mm	57.5 mm

Technical data

Nickel-plated aluminium

Very suitable for the use with PMA screening braids

Suitable with all PMA connectors

With flat gasket

Thread 1: on casing side

Thread 2: on PMA connector side

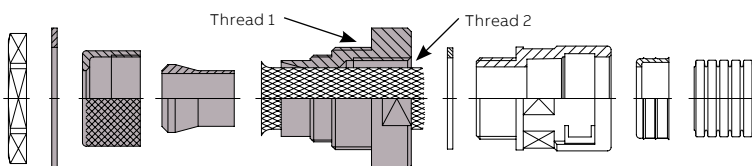

Content of delivery includes grey marked products.

EMC System

EMC connectors with strain relief



KEZ – Connector straight with strain relief, metric metal thread



Order No. black IP68 + IP69	Thread metric	Fits to NW	Clamping range	Screen Ø	Ø max.	Thread length	Overall length
NKEZ-M160/P2	M16 x 1.5	10	5.0–8.0 mm	2.5–6.0 mm	25.0 mm	6.0 mm	54.5 mm
NKEZ-M160/P3	M16 x 1.5	10	6.5–9.5 mm	2.5–6.0 mm	25.0 mm	6.0 mm	54.5 mm
NKEZ-M202/P1	M20 x 1.5	12	4.0–6.5 mm	2.5–6.5 mm	29.0 mm	6.5 mm	61.0 mm
NKEZ-M202/P3	M20 x 1.5	12	6.5–9.5 mm	3.5–6.5 mm	29.0 mm	6.5 mm	61.0 mm
NKEZ-M207/P3	M20 x 1.5	17	6.5–9.5 mm	3.5–6.5 mm	35.5 mm	6.5 mm	66.0 mm
NKEZ-M207/P5	M20 x 1.5	17	9.0–13.0 mm	6.5–10.5 mm	35.5 mm	6.5 mm	66.0 mm
NKEZ-M257/P3	M25 x 1.5	17	6.5–9.5 mm	3.0–8.0 mm	35.5 mm	7.5 mm	67.5 mm
NKEZ-M257/P5	M25 x 1.5	17	9.0–13.0 mm	6.5–10.5 mm	35.5 mm	7.5 mm	67.5 mm
NKEZ-M406/P4	M40 x 1.5	36	20.0–25.0 mm	18.5–25.5 mm	60.5 mm	8.0 mm	99.0 mm

Technical data

Pflitsch system UNI HF DICHT with UNI IRIS®-Spring

Sealing insert made of TPE-V

Very suitable for the use with shielded cables

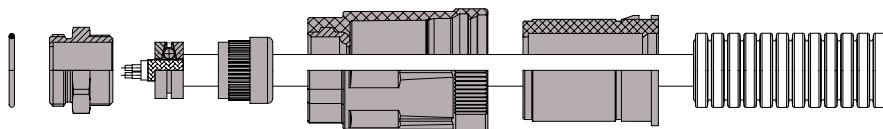

Content of delivery includes grey marked products.

EMC System

EMC connectors with strain relief



KEZ – Connector straight with strain relief, metric metal thread



Order No. black IP68 + IP69	Thread metric	Fits to NW	Fits to F.CK	Fits to F.CU	Clamping range	Thread length	Overall length
NKEZ-M160-10	M16 x 1.5	10	06	06/10	5.0–9.0 mm	10.0 mm	63.0 mm
NKEZ-M162-10	M16 x 1.5	12	10/12.5/15	10/12	5.0–9.0 mm	10.0 mm	68.5 mm
NKEZ-M202-10	M20 x 1.5	12	10/12.5/15	10/12	9.0–13.0 mm	10.0 mm	70.5 mm
NKEZ-M207-10	M20 x 1.5	17	12.5/15	12/20	9.0–13.0 mm	10.0 mm	76.0 mm
NKEZ-M253-11	M25 x 1.5	23	15/20/25	20	11.0–16.0 mm	11.0 mm	80.0 mm
NKEZ-M257-11	M25 x 1.5	17	12.5/15	12/20	11.0–16.0 mm	11.0 mm	78.5 mm
NKEZ-M323-13	M32 x 1.5	23	15/20/25	20	14.0–21.0 mm	13.0 mm	85.5 mm
NKEZ-M329-13	M32 x 1.5	29	20/25/30	20	14.0–21.0 mm	13.0 mm	90.0 mm
NKEZ-M406-13	M40 x 1.5	36	25/30/35	40	19.0–27.0 mm	13.0 mm	98.5 mm
NKEZ-M409-13	M40 x 1.5	29	20/25/30	20	19.0–27.0 mm	13.0 mm	93.0 mm
NKEZ-M506-14	M50 x 1.5	36	25/30/35	40	24.0–35.0 mm	14.0 mm	106.5 mm
NKEZ-M508-14	M50 x 1.5	48	30/35	40	24.0–35.0 mm	14.0 mm	112.5 mm
NKEZ-M638-14	M63 x 1.5	48	35	40	32.0–42.0 mm	14.0 mm	113.5 mm

Technical data

PERFECT sealing ring made from NBR

Suitable for the use with PMA screening braids or with shielded cables

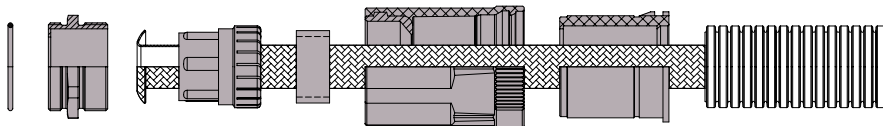

Content of delivery includes grey marked products.

EMC System

EMC connectors with strain relief



VEZ – Connector straight with strain relief, metric metal thread



Order No. black IP68	Thread metric	Fits to NW	Clamping range	Screen \varnothing	\varnothing max.	Thread length	Overall length
NVEZ-M160V/P2	M16 x 1.5	10	5.0–8.0 mm	2.5–6.0 mm	23.0 mm	6.0 mm	49.5 mm
NVEZ-M160V/P3	M16 x 1.5	10	6.5–9.5 mm	2.5–6.0 mm	23.0 mm	6.0 mm	49.5 mm
NVEZ-M160V/P3/1	M16 x 1.5	10	6.5–9.5 mm	3.5–8.5 mm	26.5 mm	6.0 mm	60.0 mm
NVEZ-M202V/P1	M20 x 1.5	12	4.0–6.5 mm	2.5–6.5 mm	26.5 mm	6.5 mm	54.0 mm
NVEZ-M202V/P3	M20 x 1.5	12	6.5–9.5 mm	3.5–6.5 mm	28.5 mm	6.5 mm	54.0 mm
NVEZ-M202V/P5	M20 x 1.5	12	9.0–13.0 mm	6.5–10.5 mm	26.0 mm	6.5 mm	54.0 mm
NVEZ-M207V/P3	M20 x 1.5	17	6.5–9.5 mm	3.5–6.5 mm	31.0 mm	6.5 mm	60.0 mm
NVEZ-M207V/P5	M20 x 1.5	17	9.0–13.0 mm	6.5–10.5 mm	31.0 mm	6.5 mm	60.0 mm
NVEZ-M257V/P3	M25 x 1.5	17	6.5–9.5 mm	3.0–8.0 mm	31.0 mm	7.5 mm	61.5 mm
NVEZ-M257V/P5	M25 x 1.5	17	9.0–13.0 mm	6.5–10.5 mm	31.0 mm	7.5 mm	61.5 mm
NVEZ-M406V/P4	M40 x 1.5	36	20.0–25.0 mm	18.5–25.5 mm	60.5 mm	8.0 mm	98.5 mm

Technical data

Pflitsch system UNI HF DICHT with UNI IRIS®-Spring

Sealing insert made of TPE-V

Very suitable for the use with shielded cables

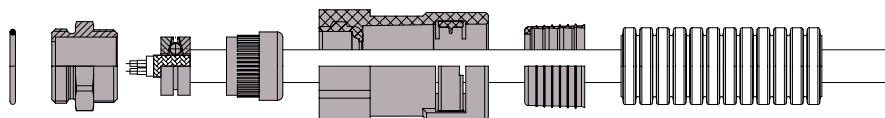

Content of delivery includes grey marked products.

EMC System

EMC connectors with strain relief



VEZ – Connector straight with strain relief, metric metal thread



Order No. black IP68	Thread metric	Fits to NW	Fits to F.CK	Fits to F.CU	Clamping range	Thread length	Overall length
NVEZ-M120V-10	M12 x 1.5	10	06	06/10	3.0–6.0 mm	10.0 mm	53.5 mm
NVEZ-M160V-10	M16 x 1.5	10	06	06/10	5.0–9.0 mm	10.0 mm	60.0 mm
NVEZ-M162V-10	M16 x 1.5	12	10/12.5/15	10/12	5.0–9.0 mm	10.0 mm	61.5 mm
NVEZ-M202V-10	M20 x 1.5	12	10/12.5/15	10/12	9.0–13.0 mm	10.0 mm	64.0 mm
NVEZ-M207V-10	M20 x 1.5	17	12.5/15	12/20	9.0–13.0 mm	10.0 mm	70.0 mm
NVEZ-M253V-11	M25 x 1.5	23	15/20/25	20	11.0–16.0 mm	11.0 mm	78.5 mm
NVEZ-M257V-11	M25 x 1.5	17	12.5/15	12/20	11.0–16.0 mm	11.0 mm	72.5 mm
NVEZ-M323V-13	M32 x 1.5	23	15/20/25	20	14.0–21.0 mm	13.0 mm	83.0 mm
NVEZ-M329V-13	M32 x 1.5	29	20/25/30	20	14.0–21.0 mm	13.0 mm	80.0 mm
NVEZ-M406V-13	M40 x 1.5	36	25/30/35	40	19.0–27.0 mm	13.0 mm	97.0 mm
NVEZ-M409V-13	M40 x 1.5	29	20/25/30	20	19.0–27.0 mm	13.0 mm	83.0 mm
NVEZ-M506V-14	M50 x 1.5	36	25/30/35	40	24.0–35.0 mm	14.0 mm	106.0 mm
NVEZ-M508V-14	M50 x 1.5	48	30/35	40	24.0–35.0 mm	14.0 mm	105.0 mm
NVEZ-M638V-14	M63 x 1.5	48	35	40	32.0–42.0 mm	14.0 mm	106.0 mm

Technical data

PERFECT sealing ring made from NBR

Suitable for the use with PMA screening braids or with shielded cables

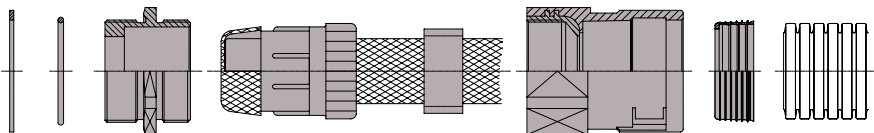

Content of delivery includes grey marked products.

NVEZ connectors with PG thread on request.

EMC System

Accessories



MM – Hexagonal lock nut for EMC applications, metric thread

- For earthing in EMC applications

Order No. metal/metric	Fits to thread metric	Wrench size	Height
GMM-M12/EMV	M12 x 1.5	15 mm	4.7 mm
GMM-M16/EMV	M16 x 1.5	19 mm	4.7 mm
GMM-M20/EMV	M20 x 1.5	24 mm	4.7 mm
GMM-M25/EMV	M25 x 1.5	30 mm	5.2 mm
GMM-M32/EMV	M32 x 1.5	36 mm	5.7 mm
GMM-M40/EMV	M40 x 1.5	46 mm	6.5 mm
GMM-M50/EMV	M50 x 1.5	60 mm	6.5 mm
GMM-M63/EMV	M63 x 1.5	70 mm	7.0 mm

Technical data

Nickel-plated brass

With cutting edges to penetrate varnish, powder coatings and anodised surfaces ensuring optimum electrical contact in EMC applications

Maximum possible torque

Safe system connection

EMC System

Accessories

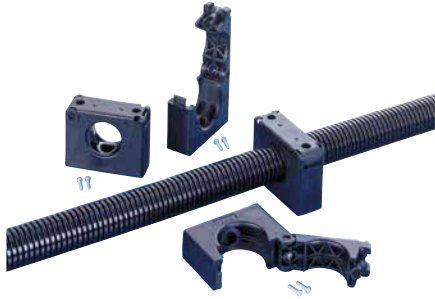

GPS – System support, one-piece, stackable

Order No.	Fits to conduit size		Width x Height x Depth
	NW	metric	
BGPS-12/01	12	16	70.0 x 51.0 x 30.0 mm
BGPS-17	17	20	70.0 x 51.0 x 30.0 mm
BGPS-23	23	25	70.0 x 51.0 x 30.0 mm
BGPS-29	29	32	85.0 x 65.0 x 30.0 mm
BGPS-36	36	40	85.0 x 65.0 x 30.0 mm
BGPS-48	48	50	115.0 x 92.5 x 30.0 mm
BGPS-56	56	–	115.0 x 92.5 x 30.0 mm

Technical data

Heavy design, high retention forces

Applicable with standard metal C rails

Clasp for easy pre-mounting and final assembly

Especially suitable for dyn. applic. due to rounded edges

The following nominal widths can be combined for stacking: NW 12 with NW 17 + 23, NW 17 with NW 23, NW 29 with NW 36, NW 48 with NW 56

EMC System

Accessories

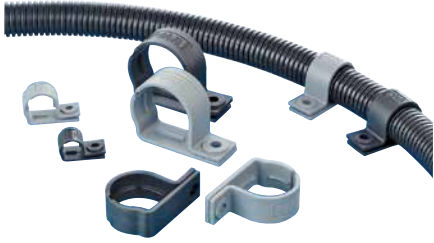

GL – Tube clamp, one-piece

Order No. black	Order No. grey	Fits to conduit size		Width	Fixing screws
		NW	metric		
BGL-07	SGL-07	07	10	25.0 mm	1 x M4
BGL-10	SGL-10	10	12	27.0 mm	1 x M4
BGL-12	SGL-12	12	16	31.0 mm	1 x M4
BGL-17	SGL-17	17	20	39.5 mm	1 x M5
BGL-23	SGL-23	23	25	49.0 mm	1 x M5
BGL-29	SGL-29	29	32	57.0 mm	1 x M6

Technical data

Integrated rib provides axial strain relief

Allows turning of the conduit, thus avoiding torsion stresses

Pre-fixation on the conduit possible

EMC System

Accessories



GH – Tube clamp, one-piece

Order No. black	Order No. grey	Fits to conduit size		Width	Fixing screws
		NW	metric		
BGH-23	SGH-23	23	25	16.0 mm	2 x M5
BGH-29	SGH-29	29	32	19.0 mm	2 x M6
BGH-36	SGH-36	36	40	24.0 mm	2 x M6
BGH-48	SGH-48	48	50	24.0 mm	2 x M6

Technical data

Integrated rib provides axial strain relief

Allows turning of the conduit, thus avoiding torsion stresses

Pre-fixation on the conduit possible

Allows solid fixation with 2 screws

EMC System

Accessories



SGB – Tube clamp

- For fixation of static conduits

Order No.	Fits to conduit size		Width	Fixing screws
	NW	metric		
SGB-07	07	10	13.0 mm	1 x M4
SGB-09	10	12	13.0 mm	1 x M4
SGB-11	12	16	13.0 mm	1 x M4
SGB-16	17	20	15.0 mm	1 x M5
SGB-21	23	25	15.0 mm	1 x M5
SGB-29	29	32	19.0 mm	1 x M6
SGB-36	36	40	19.0 mm	1 x M6
SGB-48	48	50	19.0 mm	1 x M6

Technical data

Galvanized steel

Elastomer profile free from halogens (EPDM)

Smooth connection to PMA conduits

Good resistance to ozone and ageing

Temperature range: -40 °C to +120 °C

Index

Products in alphabetical order

Order No.	GID No.	Page	Order No.	GID No.	Page	Order No.	GID No.	Page
BGH-23	7TAA292720R0014	20	BVIMV-U433	7TCA292000R0992	10	NKEZ-M508-14		14
BGH-29	7TAA292720R0015	20	BVIMV-U566	7TCA292000R0993	10	NKEZ-M638-14		14
BGH-36	7TAA292720R0016	20	BVIMV-U568	7TAA292330R0038	10	NKEZ-M160/P2	7TCA292000R6245	13
BGH-48	7TAA292720R0017	20	BVIMV-U569	7TCA292000R0994	10	NKEZ-M160/P3		13
BGL-07	7TAA292720R0021	19	F.CK.03	7TAA292910R0048	4	NKEZ-M202/P1	7TCA292000R0171	13
BGL-10	7TAA292720R0022	19	F.CK.04	7TAA292910R0049	4	NKEZ-M202/P3	7TCA292000R0172	13
BGL-12	7TAA292720R0023	19	F.CK.06	7TCA292000R0152	4	NKEZ-M207/P3	7TCA292000R0174	13
BGL-17	7TAA292720R0024	19	F.CK.10	7TAA292910R0050	4	NKEZ-M207/P5	7TCA292000R5586	13
BGL-23	7TAA292720R0025	19	F.CK.12.5	7TAA292910R0051	4	NKEZ-M257/P3	7TCA292000R0177	13
BGL-29	7TAA292720R0026	19	F.CK.15	7TAA292910R0052	4	NKEZ-M257/P5	7TCA292000R6162	13
BGPS-12/01	7TCA292000R5539	18	F.CK.20	7TAA292910R0053	4	NKEZ-M406/P4		13
BGPS-17	7TAA292860R0027	18	F.CK.25	7TAA292910R0054	4	NVEZ-M120V-10	7TAA292210R0000	16
BGPS-23	7TAA292860R0028	18	F.CK.30	7TAA292910R0055	4	NVEZ-M160V-10	7TAA292210R0001	16
BGPS-29	7TAA292560R0029	18	F.CK.35	7TAA292910R0056	4	NVEZ-M162V-10	7TAA292210R0004	16
BGPS-36	7TAA292860R0030	18	F.CK.50	7TAA292910R0057	4	NVEZ-M202V-10	7TAA292210R0005	16
BGPS-48	7TAA292860R0031	18	F.CU.01	7TAA292910R0058	5	NVEZ-M207V-10	7TAA292210R0008	16
BGPS-56	7TAA292860R0032	18	F.CU.04	7TAA292910R0059	5	NVEZ-M253V-11	7TAA292210R0011	16
BVEMV-M120-10	7TAA292330R0000	8	F.CU.10	7TAA292910R0060	5	NVEZ-M257V-11	7TAA292210R0012	16
BVEMV-M120-5	7TCA292000R0949	8	F.CU.12	7TAA292910R0061	5	NVEZ-M323V-13	7TAA292210R0015	16
BVEMV-M162-10	7TAA292330R0001	8	F.CU.20	7TAA292910R0062	5	NVEZ-M329V-13	7TAA292210R0016	16
BVEMV-M162-5	7TCA292000R0950	8	F.CU.40	7TAA292910R0063	5	NVEZ-M406V-13	7TAA292210R0017	16
BVEMV-M207-10	7TAA292330R0002	8	F.CU.50	7TAA292910R0064	5	NVEZ-M409V-13	7TAA292210R0019	16
BVEMV-M207-6	7TAA292330R0003	8	F.HY.10	7TAA292910R0268	6	NVEZ-M506V-14	7TAA292210R0020	16
BVEMV-M207SW-10	7TCA292000R0951	9	F.HY.12	7TAA292910R0269	6	NVEZ-M508V-14	7TAA292210R0021	16
BVEMV-M253-11	7TAA292330R0004	8	F.HY.15	7TAA292910R0270	6	NVEZ-M638V-14	7TAA292210R0022	16
BVEMV-M253-7	7TAA292330R0005	8	F.HY.20	7TAA292910R0271	6	NVEZ-M160V/P2	7TAA292210R0002	15
BVEMV-M329-13	7TAA292330R0006	8	F.HY.35	7TAA292910R0272	6	NVEZ-M160V/P3	7TAA292210R0003	15
BVEMV-M329-8	7TAA292330R0007	8	F.HY.40	7TAA292910R0273	6	NVEZ-M160V/P3/1	7TCA292000R0213	15
BVEMV-M329SW-13	7TCA292000R0952	9	GMM-M12/EMV	7TAA292670R0042	17	NVEZ-M202V/P1	7TAA292210R0006	15
BVEMV-M406-13	7TAA292330R0008	8	GMM-M16/EMV	7TAA292670R0044	17	NVEZ-M202V/P3	7TAA292210R0007	15
BVEMV-M406-8	7TAA292330R0009	8	GMM-M20/EMV	7TAA292670R0046	17	NVEZ-M202V/P5	7TCA292000R0214	15
BVEMV-M406SW-13	7TCA292000R0953	9	GMM-M25/EMV	7TAA292670R0048	17	NVEZ-M207V/P3	7TAA292210R0009	15
BVEMV-M409-13	7TAA292330R0010	8	GMM-M32/EMV	7TAA292670R0050	17	NVEZ-M207V/P5	7TAA292210R0010	15
BVEMV-M508-14	7TAA292330R0011	8	GMM-M40/EMV	7TCA292000R0156	17	NVEZ-M257V/P3	7TAA292210R0013	15
BVEMV-M508SW-14		9	GMM-M50/EMV	7TCA292000R0157	17	NVEZ-M257V/P5	7TAA292210R0014	15
BVEMV-M508-9	7TAA292330R0012	8	GMM-M63/EMV	7TCA292000R6620	17	NVEZ-M406V/P4	7TAA292210R0018	15
BVEMV-M638-10	7TAA292330R0013	8	HFAK-M32/25-13	7TAA292330R0040	12	SGB-07	7TAA292720R0027	21
BVEMV-M638-14	7TAA292330R0014	8	HFAK-M40/32-13	7TAA292330R0042	12	SGB-09	7TAA292720R0029	21
BVEMV-M638SW-14	7TCA292000R0955	9	HFAK-M50/40-14	7TAA292330R0044	12	SGB-11	7TAA292720R0031	21
BVIMV-U182	7TCA292000R0988	10	HFAK-M63/63-14	7TAA292330R0045	12	SGB-16	7TAA292720R0036	21
BVIMV-U212	7TCA292000R0989	10	NKEZ-M160-10		14	SGB-21	7TAA292720R0039	21
BVIMV-U212-14	7TAA292330R0029	11	NKEZ-M162-10	7TCA292000R0170	14	SGB-29	7TAA292720R0043	21
BVIMV-U247	7TCA292000R0990	10	NKEZ-M202-10		14	SGB-36	7TAA292720R0044	21
BVIMV-U247-14	7TAA292330R0030	11	NKEZ-M207-10	7TCA292000R0175	14	SGB-48	7TAA292720R0046	21
BVIMV-U267-14	7TAA292330R0031	11	NKEZ-M253-11	7TCA292000R0176	14			
BVIMV-U293-14	7TAA292330R0032	11	NKEZ-M257-11	7TCA292000R0178	14			
BVIMV-U303-14	7TAA292330R0033	11	NKEZ-M323-13	7TCA292000R0179	14			
BVIMV-U323-14	7TAA292330R0034	11	NKEZ-M329-13	7TCA292000R7908	14			
BVIMV-U353	7TAA292330R0035	10	NKEZ-M406-13	7TCA292000R0180	14			
BVIMV-U357	7TAA292330R0036	10	NKEZ-M409-13	7TCA292000R0181	14			
BVIMV-U359-14	7TAA292330R0037	11	NKEZ-M506-14	7TCA292000R0182	14			